

2024 - 2025
Yearly Publish

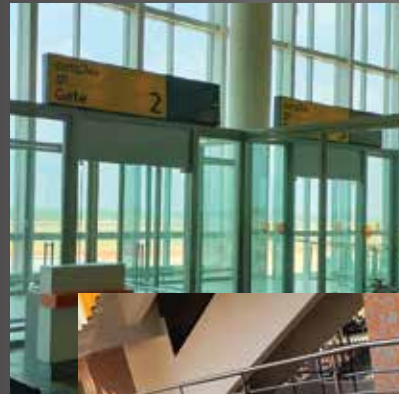

Our Journey from
2013, in ten years
achieve the mile
stone of ₹ 22.41 cr



RANIHATI CONSTRUCTION PRIVATE LIMITED

(Engineers Cum Contractor)



**Do good work and keep 100% time and commitment,
dedication and devotion. We change ourselves over time.**

We Do Civil Finishing Solution & Core Solution -

1)Facade work. (Glass Facade - unitized/semi unitized/spider/Louver)

2)Cladding Work. (ACP/Stone/Metal/Perforation/Louver)

3)Canopy (Glass/ACP/Hanging/Other)

4)Louver (in variant system.)

5)False Ceiling (Gypsum/Calcium/Metal/Other)

6)Flooring (Vitrified Tiles Flooring/Granite Flooring / Marble Flooring/Kota Stone Flooring/Epoxy Flooring/PU Flooring/False Flooring)

7)Partition (Gypsum / Aluminium / Wooden / Fire rated)

8)Insulation (Thermal / Noise Barrie)

9)SS Hand Railing

10)Gypsum Plaster/Putty/Paint

OUR BRANDS-





RANIHATI CONSTRUCTION PVT. LTD.

(Engineers Cum Contractor)

Dear Sir,

We would like to introduce ourselves as "Ranihati Construction Pvt. Ltd.," a leading civil finishing firm with a registered office in West Bengal. Our presence spans across Pan India. We specialize in various types of Civil Finishing & Core Civil .

Our journey began in 2013 as a proprietorship firm called "Radiance Construction," focusing on providing quality service to Civil finishing cum contractors. Fast forward from 2013 to 2024, in just 11 years, we are pleased to announce significant growth as a company while maintaining our strong ethos of delivering quality work within the scheduled time. We have expanded our number of projects.

We have now evolved to the more fitting name of "Radiance Construction" and rebranded as "Ranihati Construction Private Limited," offering a range of services. This transformation aims to be a genuine and flexible contractor in the civil finishing market. To accommodate our expanding client base, our turnover has grown from 1 crore to 20 crores. Our senior management team, consisting of experienced department heads, has crafted offerings that prioritize compliance and genuine customer service, an exception rather than the rule.

Our view is simple – complete compliance as a prerequisite, followed by a strong focus on service to both agency partners and contractors. "Ranihati Construction Private Limited" employs skilled professionals and well-equipped machinery, tools, and tackles to complete projects with a commitment to safety and quality assurance within the scheduled time. These driving factors lead us in the world of civil finishing work, reaching high landmarks.

Starting our journey in 2013, we navigated through the critical stage of the Covid-19 period, gradually increasing our turnover. In the last financial year (FY 22-23), our turnover was Rs. 13.61 crores, and in the current FY 23-24, it stands at Rs. 22.41 crores.

Regd. Off- Ranihati, Amta Road. Joynagar, Panchla, Howrah-711320(W.B)

M.-9007824246 Website : rconpl.in

Email: ranihati.construction@gmail.com

GSTIN : 19AAICR7604L1ZV

CIN No. : U74999WB2018PTC224615

Views of future prospects in India by MD-

SEKH ARIF HOSSAIN

Managing Director

☎️ | 📞 : +91 9007824246 / 9088511511

✉️ : arif@rconpl.in



The construction industry in India is poised for significant growth and offers promising prospects for the future.

Here are some views on the potential growth drivers and opportunities:

1. Infrastructure Development:

The Indian government's continued focus on infrastructure development through initiatives such as Bharatmala, Sagarmala, Smart Cities Mission, and the Atmanirbhar Bharat Abhiyan presents vast opportunities for the construction industry. Investments in roads, highways, railways, ports, airports, urban infrastructure, and affordable housing are expected to drive construction activity across the country.

2. Urbanization and Real Estate:

Rapid urbanization, coupled with the growing demand for commercial and residential spaces, will fuel construction activity in India's urban centers. The need for affordable housing, mixed-use developments, commercial complexes, and industrial parks will drive demand for construction services, including residential and commercial construction, infrastructure development, and real estate projects.

3. Government Initiatives:

Government policies and programs aimed at boosting the construction sector, such as Housing for All, Pradhan Mantri Awas Yojana (PMAY), and the Real Estate (Regulation and Development) Act (RERA), are expected to drive investment and growth in the industry. These initiatives focus on streamlining regulations, enhancing transparency, and increasing access to affordable housing, which will stimulate construction activity.

Views of future prospects in India by MD-

4. Smart Cities and Sustainable Development:

The Smart Cities Mission aims to transform Indian cities into sustainable and technologically advanced urban centers. Projects under this initiative, including smart infrastructure, green buildings, and intelligent transportation systems, will drive demand for construction services that prioritize innovation, efficiency, and sustainability.

5. Digitalization and Technology Adoption:

The construction industry in India is witnessing increased digitalization and technology adoption, including Building Information Modeling (BIM), advanced construction materials, prefabrication, and modular construction techniques. These innovations improve project efficiency, reduce construction time, minimize costs, and enhance quality, driving growth and competitiveness in the sector.

6. Foreign Direct Investment (FDI) and Public-Private Partnerships (PPPs):

Foreign investment inflows and partnerships with international firms are expected to play a significant role in driving growth and innovation in the Indian construction industry. FDI in real estate and construction activities, along with PPPs in infrastructure projects, will bring in capital, expertise, and technology, accelerating project implementation and expanding opportunities for domestic and foreign players alike.

7. Focus on Green and Sustainable Construction:

With increasing awareness of environmental sustainability and climate change, there is a growing emphasis on green and sustainable construction practices in India. Projects incorporating energy-efficient designs, renewable energy integration, waste management systems, and green building certifications will gain traction, driven by regulatory mandates, market demand, and corporate sustainability goals.

8. Workforce Development and Skilling:

Addressing skill shortages and enhancing workforce capabilities through training, education, and skilling initiatives will be critical for sustaining growth and innovation in the construction industry. Investments in vocational training programs, apprenticeships, and technology-oriented skill development will ensure a skilled workforce capable of meeting industry demands and driving productivity.

Overall, the construction industry in India is expected to witness robust growth driven by infrastructure development, urbanization, government initiatives, technology adoption, sustainability trends, and investment inflows. Companies that adapt to evolving market dynamics, embrace innovation, prioritize sustainability, and invest in workforce development will be well-positioned to capitalize on the opportunities and drive growth in the construction sector.



BRANCHES OF OUR COMPANY

STATE NAME	CITY	ADDRESS
WEST BENGAL	Howrah	M Plaza, Shop No-13, Ranihati, Joynagar, Panchla, Howrah-711302, W.B (GSTIN-19AAICR7604LIZV)
DELHI	New Delhi	55, 2ND Floor, Lane-2, Westend Marg, Saidullajab, New Delhi, Delhi (GSTIN-)
MAHARASHTRA	Borivali	Sureshwari Techno It Park Premises, Link Road, Borivali West Mumbai, Borivali, Mumbai, (GSTIN-27AAICR7604LIZY)
TAMIL NADU	Tiruchirapalli	106, 54/1, SP Arcade, 9A Cross West Extension Thillai Nagar, Tiruchirapalli, Tamil Nadu-620018, (GSTIN-33AAICR7604LIZ5)
ASSAM	Kamrup Metropolitan	House no 14, Indrapur, Chilarai Nagar Path, Guwahati, Kamrup Metropolitan, Assam-781032, (GSTIN-18AAICR7604LIZX)
MADHYA PRADESH	Indore	3rd Floor, Building-305, Satguru Parinay, PU3, A.B. Road, Indore, Madhya Pradesh-452010, (GSTIN-23AAICR7604LIZ6)
CHHATTISGARH	Raipur	Ground floor, GORE PARISAR, Raipur-Chhattisgarh 492001 (GSTIN-22AAICR7604LIZ8)
JHARKHAND	Ranchi	Plot No 121,124, Namkum Silwai, Ranchi, Jharkhand-835103 (GSTIN-20AAICR7604LIZC)
UTTAR PRADESH	Lucknow	547/KA/149, Rajajipuram, Sheetla Puram, Lucknow, Uttar Pradesh-226017 (GSTIN-09AAICR7604LIZW)
ODISHA	Khordha	Plot No-412/885, Jatni, Sandhapur, Khordha Odisha-752050 (GSTIN-21AAICR7604LIZA)
BIHAR	Wets Champaran	2nd Floor, Ward No 26, Mitra Chawk, Gaj No - 2, Bettiah, Wets Champaran, Bihar-845438, (GSTIN-10AAICR7604LIZD)

COMPANY GROWTH CHART

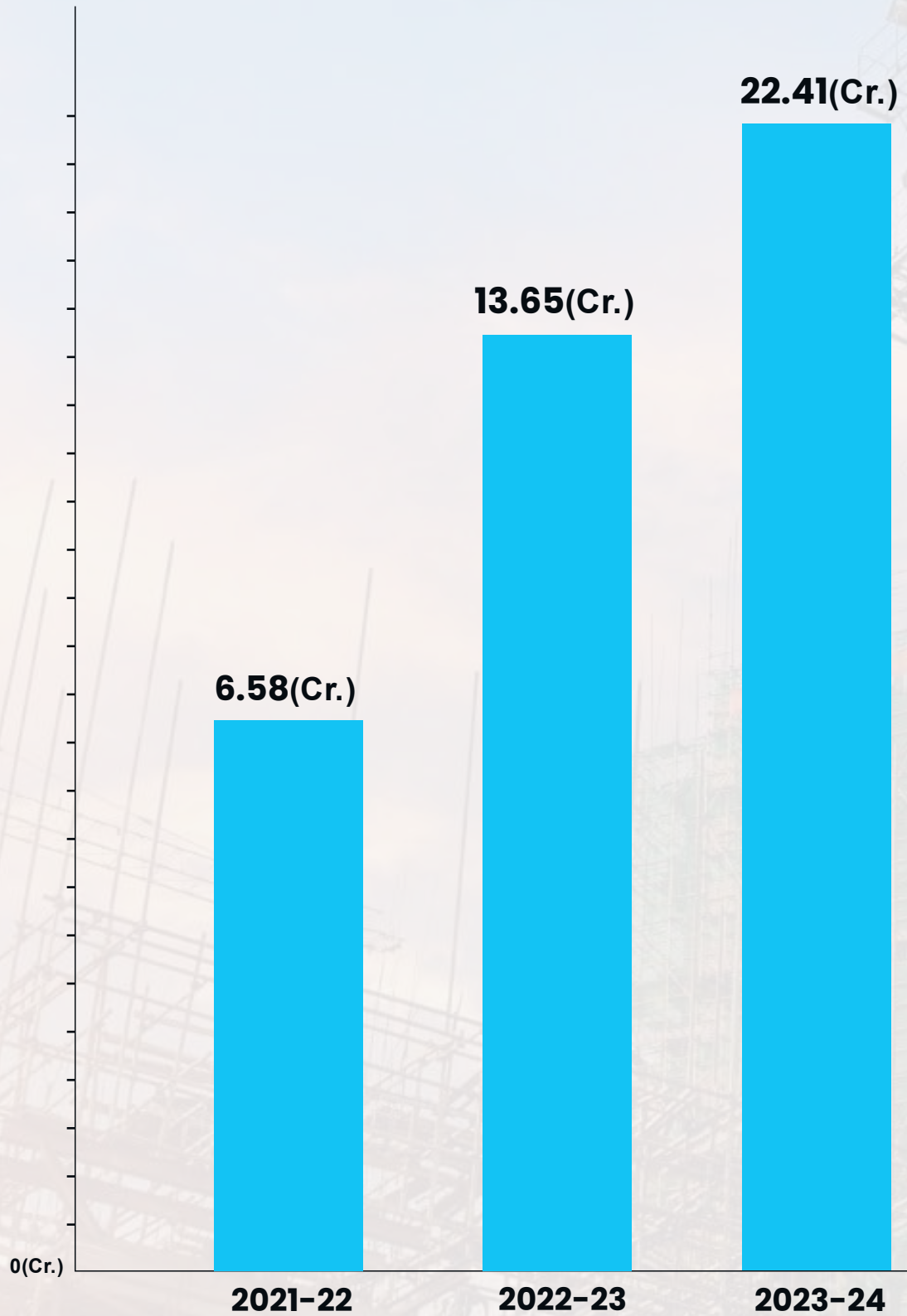

OUR CLIENTS

- **Mumbai Metro Rail Corporation Ltd.**
- **ITC Limited**
- **Itd Cementation India Ltd.**
- **Kalpataru Projects International Ltd.**
- **Godrej Properties Ltd.**
- **Power Mech Projects Ltd.**
- **Larsen & Toubro Ltd.**
- **Godrej & Boyce Manufacturing Co. Ltd.**
- **Shapoorji Pallonji Group**
- **Hindustan Construction Company**
- **Tata projects Ltd.**

Company Detail

- **Company CIN No. - U74999WB2018PTC224615**
- **Company PAN No. - AAICR7604L**
- **Company MSME-UAM No. - WB08E0012709**
- **Company ESI No. - 41000707590000999**
- **Company PF No. - WBHL01826861000**
- **Company Importer- Exporter Code - AAICR7604L**

COMPLETED PROJECTS

SI NO.	OUR PROJECTS SEGMENT	NAME OF THE PROJECT	ITEM EXECUTED
1	Airport	Pune International Airport -AAI-ITD	Structure Glazing, ACP Cladding & Wall panelling, Glass Partition, Aluminium Door Window, Glass door, MS Structure Work
2	Metro Rail UG	Phoolbagan, Kolkata, KMRCL	Vensaft Louver, Tom ECR Laminated Glass, Spider Glazing, Smoke Barreer work, False ceiling
		Sealdah Metro Station, Kolkata	Aluminium & louver, Counter Glass, MS Perforated Sheet Work
		Mhakaran Metro B.B.D. Bagh, Kolkata	Bulkhead Work
		HOWRAH MOIDAN METRO- AFCONS -RC	Bulkhead Work, Counter Glass, Smoke barrier
		HOWRAH STATION Metro - GODREJ- RCPL	Bulkhead Work
3	Metro Rail Elevator	Sector-V to Stadium	Alu Louver work, Acp
		NOAPARA-DAKSHINESWER-RVNL	False ceiling, Aluminium & louver, Counter Glass, ACP
		JOKA TO BBD BAG METRO	SS hand rail, Counter glass, Aluminium, false ceiling
		NEW GARIA TO AIRPORT METRO CORRIDOR- RVNL-ANS 1	False ceiling, Aluminium & louver, Counter Glass, ACP
		JOKA TO BBD BAG METRO Kolkata 700104	False ceiling, Aluminium & louver, Counter Glass, ACP
		NAGPUR METRO RAIL CORPORATION LTD NAGPUR, MAHARASTRA.	False ceiling, Aluminium & louver, ACP, Structure Glazing
		TARATALA-MAJERHAT-BEHALA METRO Kolkata Behala, Taratola	False ceiling, Aluminium & louver, Counter Glass, ACP
		RVNL ITDANS 3RCPL	False ceiling, Aluminium & louver, Counter Glass, ACP
		BDPL - (PD) MH	False ceiling, Aluminium & louver, Counter Glass, ACP
		BDAPLANS 2 - RCPL	False ceiling, Aluminium & louver, Counter Glass, ACP
4	Residential Housing	NOAMUNDI TOWNSHIP PROJECT, Jharkhand	Aluminium work
		NOAMUNDI TOWNSHIP PROJECT, Jharkhand	Aluminium Door Window work
		NLMK INDIA Coating Private Limited SECTOR-13, AURANGABAD, Maharashtra	Aluminium Door Window work
		Godrej Platinum - RC	Aluminium Door Window work
		NOAMUNDI TPL HOUSE	Aluminium Door Window work

COMPLETED PROJECTS

SI NO.	OUR PROJECTS SEGMENT	NAME OF THE PROJECT	ITEM EXECUTED
5	Power Plant	TATA STEEL PLANT - PHASE 1, JAJPUR, KALINGANAGAR, ODISHA	Aluminium Partition, CID proof Tiles Underdeck Insulation, False Ceiling False Flooring, Partition
		SINGRENI THERMAL POWER STATION, SINGRENI, Manchiral Telengana	Acid Proof Tiles work
		Durgapur Projects Ltd (DPL) DURGAPUR, WB	Aluminium & Partition
		India Power Corporation Limited (IPCL) HALDIA, WB	Acid Resistant Tiles & Paint
		BARUNI THERMAL POWER STATION, BARUNI, BIHAR	Aluminium & Partition, False Ceiling Acid Resistant Tiles & Paint
		NTPC-TOWNSHIP PROJECT, NABINAGAR	Aluminium Door Window Work
		IOCL MANGALAM ODISHA	Aluminium Door Window Work
		Unchahar Thermal Power Station	Aluminium Door Window Work
6	Steel Plant	TATA STEEL PLANT, KALINGA NAGAR - TPL Odhisa	Underdeck Insulation, False Ceiling
		Unchahar Thermal Power Station (1 X 500 MW), Unchahar, UP	Aluminium work
		TATA STEEL PLANT, KALINGA NAGAR - TPL Odhisa	Aluminium Door Window Work, Under deck Insulation Work
		KEONJHOR - RC	Fire door
		NLMK Housing Project	Aluminium Door Window Work
7	Industrial Office Complex	BASF Chemical Complex DAHEJ, BHARUCH, GUJRAT	Insulating, False Ceiling, Glazing, Granite Flooring
		INDIRA GANDHI AUTOMIC RESEARCH CENTRE, FRFCF, KALAPAKKAM, CHENNAI	False Ceiling Works
		GOA SHIPYARD LTD, VASCO DA GAMA, GOA	Aluminium Door, Window Louver
		GOA SHIPYARD LTD Vasco da Gama, Goa	False ceiling, Aluminium & louver, Counter Glass, ACP
		GOA SHIPYARD LTD New Vaddem, Vasco da Gama	SS RAILING, Alu Door-Window
8	Public office Building	HOJ TOWER COMPLEX RAJARHAT, NEW TOWN	Structural Glazing, Aluminium Door, Window, Furniture

COMPLETED PROJECTS

SI NO.	OUR PROJECTS SEGMENT	NAME OF THE PROJECT	ITEM EXECUTED
9	Instituitinal Building	IIT ROPAR, Roper, PUNJAB	Aluminium, Glazing & ACP
		CENTRAL UNIVERSITY BIHAR GAYA (CUBG) Bihar	Aluminium & Fire line partition
		UNIFIED CAMPASS OF BOSE INSTITUTE SALT LAKE, SEC V, KOLKATA	Structural Glazing, & False ceiling
		SHIV NADAR UNIVERSITY - DADRI Noida, Uttar Pradesh	Aluminium Door Window Work
		IIT BHUBANESWER Jatni, ODISHA	Aluminium Door Window Work
		NALANDA UNIVERSITY	Grid False Ceiling, Seamless false Ceiling, Wooden False Ceiling
10	IOCL Refinery	RATHCHAKRA PROJECT- IOCL PARADEEP, ODISHA	Aluminium & Other Work Light Weight Partition Work
		IOCL, Paradeep, Substation Odisha	Aluminium Louver
11	Medical college Building	MEDICAL COLLEGE DIMONDHARBOUR & PURULIA	False Ceiling Work
		BETTIAH MEDICAL COLLEGE BETTIAH, BIHAR	Aluminium Door Window Work
		Vizag Medical College- HCC	Aluminium Door Window Work, Under deck Insulation Work, False Ceiling
12	Amusement park	SOLAR DOME, Eco Park Newtown, Kolkata	Aluminium Perforation sheet, False ceiling
13	Studio Building	TELE ACADEMY KMC operated, BARUIPUR, SOUTH 24 PGS	False ceiling, Aluminium & louver, Counter Glass, ACP
14	NHAI Tollway plaza Ancillary Building	PURBANACHAL EXPRESS TOLL PLAZA BUILDING Lucknow, UP	Aluminium & louver, Counter Glass, Flooring, Cubicle Partition
15	Gas pipeline project	Kalpataru PIPE LINE IOCL - RC	Aluminium Door Window Work
16	Commercial complex	Simplycity Mart - Suri	Aluminium Work, Structure Glazing, Glass Door & Calcium Partition

COMPLETED PROJECT WORK



COMPLETED PROJECT WORK



CURRENT PROJECTS

SI NO.	OUR PROJECTS SEGMENT	NAME OF THE PROJECT	ITEM EXCICUTED
1	Airport	Trichy International Airport - AAI- ITD	Structure Glazing, ACP Cladding, False ceiling, Flooring, ALUMINIUM Door Window, Glass door, MS Structure Work
2	Metro Rail Elevator	Mumbai Metro Line-3 project	Office setup and interior, partition works
		BDPL- (PD) MH	False ceiling, Aluminium & louver, Counter Glass, ACP
		BDAPL-ANS 2 - RCPL	False ceiling, Aluminium & louver, Counter Glass, ACP
3	Residencal Housing	Godrej Se7en Tower Project	Aluminium Door Window Work
		Sukhobristi Housing Project - BSHDPL	Aluminium Door Window Work
		Renaissance Township- Shrachhi Burdwan Developers Pvt. Ltd	Aluminium Door Window Work
4	Power Plant	1 X 660 MW BHUSAWAL TPS, BSL	Aluminium Door Window Work, Under deck Insulation Work, False Ceiling
		2 x 660 MW UDANGUDI STPP (2045) TPS	ALUMINIUM Door Window WORK, Under deck Insulation Work, False Ceiling
5	Institutinal Building	Amity University- Jharkhand - SPCPL	Aluminium Door Window Work, Structure Glazing, Glass Door & Partition
6	Port Building	IOCL Captive Jetty Project- ITD CEM	Aluminium Door Window Work, Paint, False Ceiling & Tiles
7	Public Building	Guwahati Gateway Ghat, Assam- Terminal Building exterior & interior finishing Civil Work	Aluminium Door Window Work Paint, False Ceiling & Tiles

Detail of work and Making process -

FACADE WORK:

The types of Facade work we do are -

Unitize Facade: A unitized facade, also known as a unitized curtain wall system, is a modern and sophisticated architectural design and construction method commonly used in the construction of large commercial and high-rise buildings. This type of facade system involves the assembly and installation of prefabricated units or panels, typically made of glass, aluminum, steel, or other materials, onto the building's structure.

Semi-Unitize Facade: A semi-unitized facade is a type of architectural facade system that combines elements of both unitized and stick-built curtain wall systems. It offers a compromise between the two methods and is often chosen based on project-specific requirements, budget constraints, or design preferences.

Lattice Facade: A lattice facade refers to an architectural design element in which a lattice or grid-like structure is used to cover or decorate the exterior of a building. This lattice can be made from various materials, including wood, metal, or even plants like climbing vines.



Detail of work and Making process –

CLADDING WORK:

There are many kind of Cladding works, such as:

Stone Cladding: Stone cladding is a popular architectural and design technique that involves applying a layer of natural or manufactured stone to the exterior or interior of a building. It offers several benefits and can be used in various ways to enhance the appearance and functionality of a space.

ACP Cladding: ACP stands for Aluminum Composite Panel, and ACP cladding refers to the use of these panels as a cladding material for buildings and structures.

Perforated Metal Cladding: Metal perforation cladding, also known as perforated metal cladding or perforated metal panels, is a building material that offers several benefits in terms of aesthetics, functionality, and sustainability.

Hardware and Accessories for ACP Cladding:

- 19X8 SS CSK SDS PHILIPS (Frame Making Screw & Hardware Fixing)
- 10X100 Nylon Anchor Fastener (Frame Fixing Screw)
- 10X100 Mechanical Anchor Fastener (Frame Fixing Screw)
- SS 304 Nut Bolt 6X70MM Long
- 3.2X13MM Pop Rivet
- 40X402MM Nylon Separator



Detail of work and Making process –

CANOPY:

It is mainly used for change the attractive look of the area , it is make with SS structure or fin glass structure , the glass panel fixing with spider fittings.

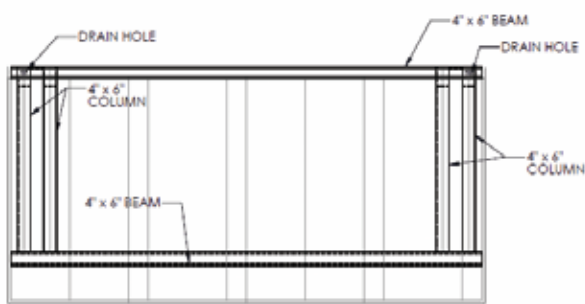

Top View

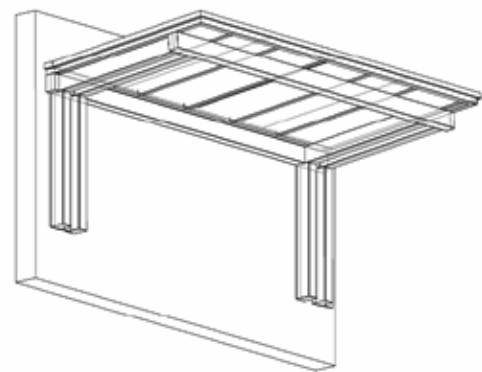

Isometric View

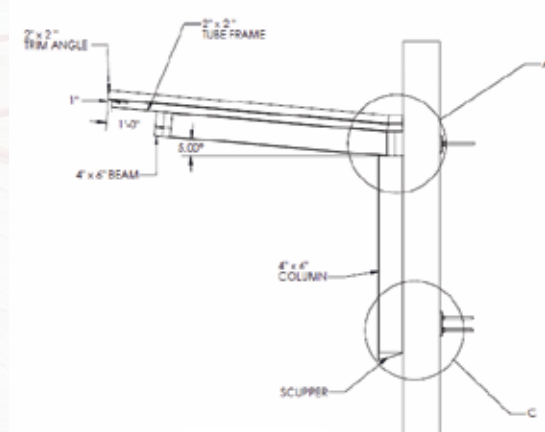

Side View

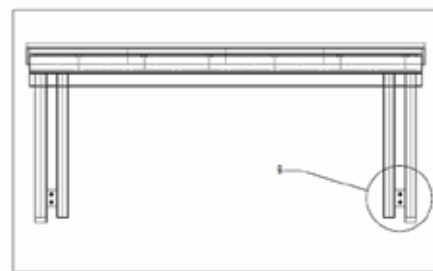

Elevation View

Detail of work and Making process -

FALSE CEILING:

The ceiling which is used mainly below the ceiling to cover up the electrical wiring and Fire fitting tube and thermal insulation for heat conduction between the building and outside, it also enhance acoustic of building.

It is mainly 3 types- 1. seamless, 2. Grid & 3. Baffle

Seamless ceiling: This types of ceiling permanent false ceiling & material are calcium silicate, gypsum. It is used where the maintain ace is less, because it can't be open & close possible except dismantle, It could be also used as design where different level of ceiling in single floor level.

Grid: These types of ceiling are temporary used where maintained are rapid, because it mainly laying up on the grid & open close possible without dismantle. There are different types of material is used such as gypsum, calcium silicate, metal both aluminium and MS colour coated. It is also be perforated or non-perforated,

Baffle: It is mainly used design purpose Baffle ceilings are ideal for creating atmosphere within a room space. These open ceiling constructions allow a view to the plenum area and concrete ceiling above. They are particularly suited for remedial installation on concrete ceilings where a distinctive design or improvement to the acoustic sound is required.



Detail of work and Making process –

LOUVERS:

Louvers can be configured to facilitate natural ventilation. This helps regulate indoor air quality, reduce the need for mechanical ventilation, and enhance occupant comfort.

Depending on their design and placement, louvers can provide privacy for building occupants. They can obstruct the view from the outside while still allowing those inside to see out.

Louvers can be used to create visually appealing façades and architectural details. The choice of materials, finishes, and louver design can contribute to the overall aesthetic of the building.

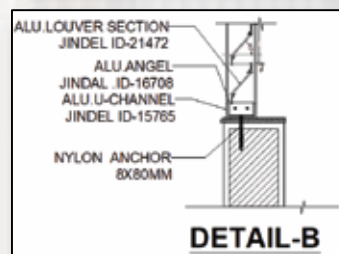
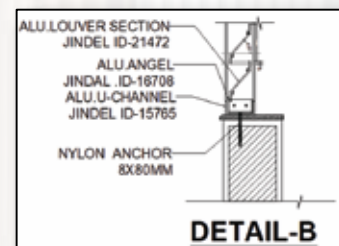
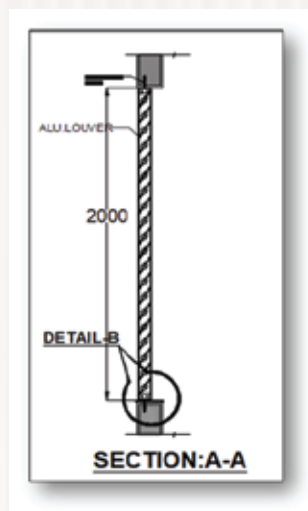
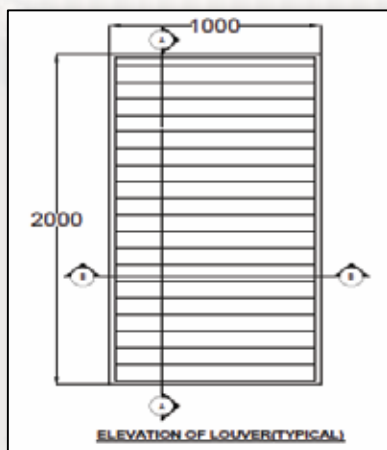

Detail of work and Making process -

INSULATION:

There are two types of Insulation we use-

Under Deck Insulation: Under deck insulation refers to the installation of insulating high value machinery in power plant beneath the flooring or decking of a structure. This insulation serves various purposes, including temperature regulation, moisture control, and soundproofing. Material used here Polystyrene board, glass wool, Rockwool, stone wool etc.

Noise Barrier: Noise barrier insulation, often referred to as soundproofing or acoustic insulation, serves several purposes and offers various benefits:

1. Noise Reduction
2. Increased Privacy
3. Improved Concentration
4. Enhanced Comfort
5. Compliance with Building Codes
6. Versatility
7. Energy Efficiency
8. Environmental Benefits



Under Deck Insulation



Noise Barrier

Detail of work and Making process –

SPIDER GLAZING:

Spider glazing is a structural glazing system used in modern architecture for the facades of buildings, particularly for large glass surfaces such as curtain walls and skylights. It's called "spider" glazing because of the spider-like fittings that connect the glass panels to the building structure. Here are the benefits, usage, and appearance of spider glazing:

Spider glazing systems are engineered to withstand wind loads, thermal stress, and other environmental factors. The hardware is typically made from materials like stainless steel or aluminum, which are corrosion-resistant and durable.

Spider glazing provides a sleek and minimalist look to buildings. It eliminates the need for visible framing elements (such as mullions and transoms) that can obstruct views and create a more open and transparent appearance.

Spider glazing allows for abundant natural light to enter the building, enhancing the interior spaces and reducing the need for artificial lighting during the day. This can lead to energy savings. It is highly versatile in terms of design and can be used in various architectural styles, from modern and contemporary to more traditional.

Most Using Accessories–



Detail of work and Making process -

WALL PANELLING:

It is mainly 4 types depending upon the material used-

ACP panelling: After aluminium framing ACP panel fixing with frame.

Wooden panelling: After main structure the wooden panel fixing with main frame.

Stone cladding: It is fixing with wall with clip upon the back structure.

GRC panelling: It is also fixing upon main frame, it is mainly used external surface.



Detail of work and Making process –

SS HAND RAILLING:

Stainless steel (SS) hand railing systems are commonly used in various settings for safety, aesthetic, and functional purposes.

1. Safety and Support: Handrails provide support and stability, especially on staircases, ramps, and elevated platforms, helping to prevent falls and accidents. Handrails aid individuals with mobility challenges, offering a secure grip and assistance while navigating stairs or inclines.

2. Aesthetic Appeal: Stainless steel handrails have a sleek and modern appearance that complements various architectural styles and interior designs.

3. Hygiene and Cleanliness: Stainless steel is non-porous and easy to clean, making handrails resistant to bacteria, mold, and mildew growth. This makes stainless steel handrails ideal for use in healthcare facilities, food processing plants, and other environments where hygiene is a priority.

Other benefits are:

4. Easy Installation
5. Code Compliance
6. Customization and Flexibility



Detail of work and Making process -

Partition:

Gypsum Partition-

Gypsum partition walls, also known as drywall or plasterboard partitions, are widely used in construction for interior partitioning.

1. Versatility and Flexibility
2. Speed of Installation
3. Lightweight Construction
4. Sound Insulation
5. Fire Resistance
6. Moisture Resistance



Aluminium Partition-

Aluminum partitions are widely used in commercial and residential construction for interior partitioning.

1. Durability and Strength
2. Design Flexibility
3. Speed of Installation
4. Fire Resistance
5. Sustainability
6. Low Maintenance



Fire-Rated Glass Partition-

A fire-rated glass partition is a type of partition or wall constructed using specialized fire-rated glass panels. These partitions are designed to provide both visibility and fire protection in buildings, particularly in areas where maintaining visibility or an open feel is important, such as offices, corridors, or lobbies.

Previous Work VS Present Work Pattern

Previous Work Pattern:

- We started our company as a proprietorship business format.
- We did line item on most of the projects. Also Aluminium door-windows, False Ceiling, ETC. Our team had no engineer, we knew the work practically and we executed the work for our clients.
- We worked as an investor, so we needed more fund for growing our business. This was the most important factor for our development.
- All time our target was client satisfaction and timely work done as per our commitment.
- From the first day our company's tag line was 'Total Finishing Solution'.

Present Work Pattern:

- The present days are very crucial for us, our Company is growing at its peak and we have planned to change our tag line to 'Engineers cum Contractor'
- We mostly prefer doing Facade work, Cladding Work, False Ceiling, Canopy, Louvers, Insulation, ETC. We have potential on design, execution and quality.
- We are also doing Govt. tenders job for finishing items and related Civil Items.
- We are also starting a sub vendor in Civil Core Work.
- In 2024-25 our milestone is up to 30 Cr revenue.

All Our Utility Fund, Management, Team Efficiency is loyal as we wanted it to be.



We at "DOZO" provide 2Hrs Fire Rated Door & All Types of Windows. Windows. Where we translate the vision of e translate the our clients into reality. Our Design, Manufacturing and Project management facilities are amongst the best in the country.

We based from Kolkatta-West Bengal, where we often a full range of 2Hrs Fire Rated Metal/Glazed Door Set, Clean Room Door Set, Architectural Metal Door Set, Acoustic Door Set ETC.

Product Range:

2HRS FIRE RATED METAL DOOR SET.

2HRS FIRE RATED WOODEN DOOR SET.

2HRS FIRE RATED GLAZED DOOR SET.

CLEAN ROOM DOORS SET.

ARCHITECTURAL DOOR SET.

AUCOSTIC DOOR SET.

SHEET METAL CLADDING PANELS.

ALLUMINIUM DOORS & WINDOWS

UPVC DOORS & WINDOWS & etc.



+91 90078 24246 inquiry@rconpl.in

Ranihati, Joynagar, Panchla, Howrah – 711302



SERVICES :

- ◆ Aluminium Powder Coating Services
- ◆ Ms Powder Coating Services
- ◆ Powder Coating Services
- ◆ Powder Coating Cabinet
- ◆ Rack Services
- ◆ Zinc Plating
- ◆ Nickel Plating
- ◆ Anodising Services



Contact us :

☎ +91 90882 42431 / +91 76050 34970

📍 Hanuman Mandir, Sankaril Industrial Park,
Dhulagori, Howrah, West Bengal-711302

✉ inquiry@rconpl.in



RADIANCE-INTERIOR
MAKE YOUR DREAM HOME IN REALITY

SERVICES :

- ◆ Home Interior
- ◆ Office Floor to Ceiling Interior
- ◆ Furniture Interior
- ◆ Glass Partition Interior
- ◆ Kitchen Interior



Contact us :

+91 90078 24246 inquiry@rconpl.in

M Plaza, Ranihati, Joynagar, Howrah – 711302



EZNIRMAN

EASY CONSTRUCTION MANAGEMENT

We manage our-

- Materials
- Manpower
- Machines
- Stock
- Daily work report
- Safety report
- Quality

By

EZNIRMAN



DOWNLOAD NOW



FOLLOW US :



Radiance Construction to Ranihati Construction Pvt. Ltd. Turned over

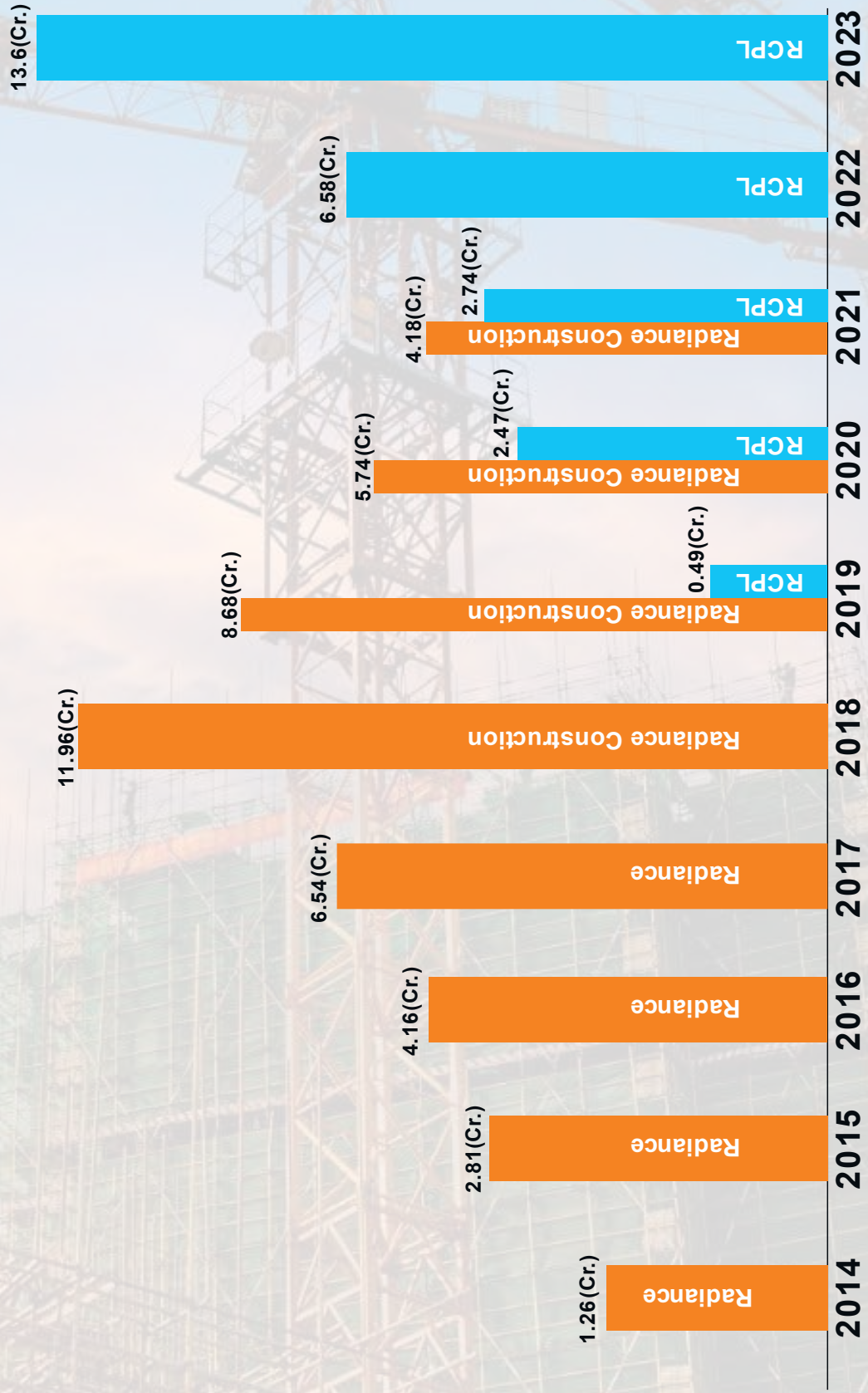

Our Ref: EWSAFEM/KMRC/ITD/511

Your Ref:

Date: 07.03.2017

M/s. ITD Cementation India Limited
Godrej Waterside, Tower 1, Office No. 803,
8th Floor, Block-DP, Salt Lake,
Sector-V, Kolkata – 700 091

General Consultants
Kolkata East West Metro

KMRCL, Munshi Premchand Sarani
Kolkata – 700 021

Tel.: +91 33 22622941

Fax:

Email: -

Attention: Mr. Mainuddin Ahmed, Project Manager

Work: "Architectural Finishing, Plumbing, Tube well, VAC, Electrical, Fire Fighting works for 6 Elevated stations including lighting of Viaduct & lighting of TSS/ASS of Car Depot and RCC Structural roof over Platform of Sector-V Station of East West Corridor of Kolkata Metro". Contract No. EWSAFEM

Subject: Approval of Vendor for Aluminium Work

Dear Sir,

This has reference to your letter no. ITDCM/KMRCL/2017/PN/529 dated 20.02.2017 through which you have had submitted the credential of M/s. Radiance Construction as a Vendor for Aluminium Work.

This is to inform you that competent Authority of KMRCL has accepted your proposal (copy enclosed). You are requested to advise the Vendor to start the work immediately.

Thanking you

Yours faithfully

MYCEL Consortium

Dipankar Paul
(Dipankar Paul)

PM/Elevated & Depot



Encl: As above

CC: Mr. N C Karmali, GM (Civil), KMRCL
Mr. Avijit Chakraborty, EE-II, KMRCL
Mr. Ken Wong, PD, MYCEL



रेल विकास निगम लिमिटेड
Rail Vikas Nigam Limited

(A Government of India Enterprise)

Kolkata Project Implementation Unit

Metro Railway Construction Office Building (Gr. Floor)
(Near Kavi Subhash Metro Railway Station)

P.O. - Panchasayar, P.S. - Patuli, Kolkata - 700 094

Tel. : 91-33-2436-0247

Fax : 91-33-2436-0247

e-mail : cpmlnekolkata@gmail.com

No. RVNL/KOL/NEW GARIA – AIRPORT/METRO/ANS-1/2013/ITDCIL/1828

Date: 24.11.2017

To

Project Manager

M/s. ITD Cementation India Limited,

Godrej Waterside, Tower No. 1, Office #803,
8th Floor, Plot no. 5, Block – DP, Sector – V,
Salt Lake City, Kolkata – 700 091.

Sub: ANS-1 "Construction of Seven (07) stations including related works from Kavi Subhas (New Garia) to Ritwik Ghatak in New Garia- Airport Metro Corridor of Kolkata Metro Railway Line.

Reg: **Approval of Vendor for Aluminium works in door and window.**

Ref: (i) LOA no. RVNL/KOL/NEW GARIA – AIRPORT/METRO/ANS-1 ANS-2 ANS 3/2013 dated 05.03.2014.
(ii) Your Letter no. - ITDCM/RVNL/2017/PN/2245 dated 16.11.2017.

Dear Sir,

In reference to your letter referred (ii) above, the vendor M/S Radiance Construction, Ranihati, Arnia Road, Joynagar, Panchla, Howrah-711302 is hereby approved for aluminium works in door and window against BOQ item no. 9.0 of Schedule A-2.

However, it should be ensured that material is supplied as per Technical Specification in Contract agreement and also the material should be got passed by RVNL before use in work.

This has got approval of Competent Authority.

Thanking you.

Yours sincerely,

(B.K. Prasad)

Dy. GM (P)/ANS – 1

Rail Vikas Nigam Limited, Kolkata

CC: Chief Project Manager/Line/Kolkata/RVNL for information please.

Regd. Off. : Plot No. 25, (1st Floor), August Kranti Bhavan, Bhikaji Cama Place, New Delhi - 110066
Tel. : +91 11 26738295 / 26738395 / 26738495, Fax : +91 11 26182957, Web : www.rvnl.org



भारतीय विमानपत्तन प्राधिकरण AIRPORTS AUTHORITY OF INDIA



(By e-mail only)

दिनांक: 01.11.2022

संदर्भ संख्या: AAI/Pune/GM(P)/NITB/Civil/2022-23/162

सेवा में,

मैसर्स आईटीडी सीमेंटेशन इंडिया लिमिटेड,

9 वां मंजिल, प्राइमा बे, टावर-बी

गेट नं-5, साकी विहार रोड,

पोवई, मुंबई- 400072

To,

M/s ITD Cementation India Limited,

9th Floor, Prima Bay, Tower-B

Gate No. 5, Saki Vihar Road,

Powai, Mumbai-400072

Through GM(Engg-Project)

Gagan Chahal
01/11/22

विषय: पुणे हवाईअड्डा, पुणे में नई एकीकृत टर्मिनल बिल्डिंग का निर्माण, पुरानी टर्मिनल बिल्डिंग का पुनर्निर्माण, मौजूदा विस्तारित टर्मिनल बिल्डिंग का संशोधन।

Subject:- Construction of New Integrated Terminal Building, Reconstruction of Old Terminal Building, Modification of Existing Expanded Terminal Building at Civil Enclave Pune Airport, Pune.

Sub Head:- Approval of specialized agency for Internal Glass partitions and ACP cladding work.

Agreement No. AAI/CHQ/ENGG(C)WR/PUNE/NITB/2018-19 Dated 25.10.2018.

महोदय,

With reference to your letter no. ITD Cem/Pune Airport/2022/Civil/3008 dated 25.10.2022 and M/s Egis India recommendation vide letter no. Egis India/AAI/Pune/2022/88684 dated 31.10.2022 on above; approval of competent authority is hereby conveyed for the agency M/s Ranihati Construction Pvt. Ltd., Howrah to work as Specialized agency for the work of Internal Glass partitions and ACP cladding under the project work.

भवदीय

टी. के. दत्ता
01/11/22
(टी. के. दत्ता)

संयुक्त महाप्रबंधक(अभि-सि)

भाविप्रा, पुणे हवाईअड्डा, पुणे

महाप्रबंधक(अभि-परि) कार्यालय
पुणे विमानतल, पुणे-411032
दूरध्वनी: (020)-26687271
ई-मेल: gmenggpripune@aai.aero

महाप्रबंधक(अभि-परि) कार्यालय
पुणे हवाईअड्डा, पुणे-411032
दूरभाष: (020)-26687271
ई-मेल: gmenggpripune@aai.aero

O/o General Manager(Engg-Proj.)
Pune Airport, Pune-411032
Phone: (020)-26687271
E-mail- gmenggpripune@aai.aero

ISO 9001:2015

Certificate of Registration

This is to Certify That
Quality Management System of

has been assessed and found to conform to the requirements of

ISO 9001:2015

for the following scope :



Demul..

DIRECTOR

Magnitude Management Services Pvt. Ltd.



Third Floor, A-60, Sector-2, Noida, Gautam Buddha Nagar, U.P.-201301, India. e-mail: info@mmscertification.com, website: www.mmscertification.com

*Subject to Successful Surveillance Audit in case Surveillance audit is not allowed to be conducted, this certificate shall be suspended/withdrawal

Certificate Verification: Please Re-check the validity of certificate at <http://www.mmscertification.com/activeclients.aspx> or www.mmscertification.com at Active Clients.
Certificate is the property of Magnitude Management Services Pvt. Ltd. and shall be returned immediately when demanded.

SSPLGROUP

 ssplgroup.info



SUMATRA

Market Place

 www.sumatra.in | APP:  | 

Sumatra is an e-commerce website known for its exceptional offers of products at significantly lower prices than other online platforms. Be it electronics, fashion or household items, Sumatra offers a wide range of products at a fraction of the cost found elsewhere. This distinctive feature makes it a destination for savvy shoppers looking for great deals and bargains.

Sumatra also serves as an optimal platform for e-commerce sellers, providing an attractive opportunity for the best sellers to showcase and sell their products. With the lowest commission in the market and a convenient return process, sellers can enjoy a seamless experience. Additionally, extensive support is available from the head office located in Sumatra, ensuring that sellers get the support they need to thrive on the platform.



Jio ji bharka

Doctorwala

 doctorwala.info | APP: 

Doctorwala.info is a comprehensive online platform designed to offer detailed information about various healthcare facilities such as clinics, OPDs, and pathology labs. The platform aims to make it convenient for users to access information about the nearest healthcare facilities, along with their operational hours and pricing. One of the key features of the platform is its ability to allow users to compare different options and make informed decisions based on their specific needs.

In addition to providing basic details, Doctorwala.info offers an array of features aimed at assisting users in finding the best OPD and pathology services available.



Rishtawala

 rishtawala.info | APP: 



Rishtawala.info, which operates through a Franchise Platform. They are a matrimonial website, Rishtawala is a matrimonial website that offers an impressive range of features and benefits to its users. Our website is well-known for its affordability and we firmly believe that finding the right partner should not be a financial burden for anyone. We have kept our prices low to ensure that everyone can access our website without any financial constraints.

At Rishtawala, we have a zero-tolerance policy towards wrongful behaviour on our website. We will not hesitate to take legal action against any user who engages in activities such as harassment, fraud, or misrepresentation. Our team closely monitors all user activity on the website to ensure that everyone adheres to our community guidelines.

You can easily find your match by following these simple steps:

1. Sign up on their website and create a profile by providing basic information about yourself.
2. Use the search feature to find potential matches based on your preferences.
3. Express your interest in someone by sending them a message or request to connect.
4. Communicate with the other person using the website's messaging or chat feature.
5. If things progress well, you can choose to meet the person in person with necessary precautions.

Sumatra Sales Private Limited

  : 6292237200 / 9088511511

 : info@ssplgroup.info

Company CIN No. - U74999WB2018PTC224615

**Registration Address: Ranihati, amta Road, Joynagar,
Panchla, Howrah-711320(W.B)**



RCPL
(Engineers cum Contractor)

Important Staff



SK Rakibul Islam
Co-ordinator
✉ rakibul@rconpl.in
☎ 7605034970



Soumen Singharoy
Co-ordinator
✉ soumen.singharoy@rconpl.in
☎ 9831103565



SK Azaharuddin
Co-ordinator
✉ azaharuddin@rconpl.in
☎ 9830241883



Saikat Das
Tender & co-ordinator
✉ saikat.das@rconpl.in
☎ 9939444891



Payel Pal
Office Assistant
✉ payel.pal@rconpl.in
☎ 8017422388



Rubina Yashmin Khan
Office Assistant
✉ yashmin.rcpl@gmail.com
☎ 8167480172



Sayek Ali Mallick
Account & Finance
✉ sayek@rconpl.in
☎ 9830219882



Sourav Mandal
Assistant Account
✉ sourav.rcpl8@gmail.com
☎ 7605034974



Palash Patra
Drawing Management
✉ palash.rcpl@gmail.com
☎ 9163015145



Pradip Samanta
Site Supervisor
✉ pradip.rcpl@gmail.com
☎ 7605034971

☎ : 9007824246

✉ : ranihati.construction@gmail.com
: inquiry@rconpl.in
: info@rconpl.in

👤 : Ranihati, Joynagar, Panchla, Howrah-711302(W.B)